

WATCHDOC C

*New in
Watchdoc V.5.3
September 2019*

DOXENSE

47, avenue de Flandre - 59290 Wasquehal - FRANCE - www.doxense.com

CONTENTS

1. INTRODUCTION.....	3
2. THE WESPHONE	3
3. THE SAVINGS CALCULATOR	6
4. THE REPORT COMMUNICATOR.....	7

© 2019 Doxense®. All rights reserved

Watchdoc® is a registered trademark owned by Doxense. All product names or other trademarks mentioned in this document are the registered trademarks of their respective owners.

Any reproduction, even partial, by any method whatsoever, is prohibited without prior authorisation. Any electronic copy produced via photocopy, photography, film or other means constitutes an infringement.

1. INTRODUCTION

What's new since version 5.2 of Watchdoc®? This is what you will discover in this document. The improvements and new features will make the version Watchdoc® mobile easier to use and more powerful in terms of data analysis. Enjoy the new discoveries!

2. THE WESPHONE

Allow your users to overcome the geographic constraints in terms of printing. Are you tempted?

It's possible thanks to the WESphone feature, web progressive application¹ which offers Watchdoc® user the possibility of unlocking their print jobs, after having defined their properties, from their mobile phone or tablet. The fast and secure operation relies on identifying devices using a QR Code (or searching by name and identifier) and it leverages the full power of the Watchdoc® standard features for user identification and their print jobs.

This new WEB functionality is therefore accessible by all types of smartphone or tablet connected to the Internet and will adapt to different screen sizes. Its development is independent of IOS / Android, facilitating its next evolution.

Launching offer: the WESphone option is free in 2019 !

New in the Watchdoc 5.3 version and in line with our tag line "new ways to leave your mark "the WESphone expands the ways you can print!

¹ A progressive web app is a web application that consists of pages or websites that can appear to the user in the same way as native applications or mobile applications. This type of application attempts to combine the features offered by most modern browsers with the benefits of the mobile 2.3 experience. A PWA looks like a regular website, from a secured URL but allows a user experience similar to that of a mobile application, without the constraints of the latter (submission to App Stores, significant use of the device memory, ...).

Create a WES PHONE profile

This form allows you to create a new WES configuration profile

Properties

Identifier	<input type="text" value="wesphone01"/>
Name	<input type="text" value="WESphone First floor"/>
Language	<input type="text" value="Automatic detection"/>
Colour	<input type="text" value="#FF2222"/> Colour of the buttons on the screen
Images	<input type="text"/> Path to the folder containing custom images. (Leave blank to use default images)

Authentication

Directory	<input type="text" value="[Use the default directory]"/>
------------------	--

Domain used to map the PIN Code to the user account

Accessibility

All users	<input checked="" type="checkbox"/> All users can access the WesPhone corresponding to this configuration				
Restraint	<input type="checkbox"/> Only for roles <table style="width: 100%; border-collapse: collapse; margin-top: 5px;"> <tr> <td style="width: 80%; border: 1px solid #ccc; text-align: center;">Role</td> <td style="width: 20%;"></td> </tr> <tr> <td colspan="2" style="text-align: left; padding-left: 5px;"> <input type="button" value="Add role"/> </td> </tr> </table>	Role		<input type="button" value="Add role"/>	
Role					
<input type="button" value="Add role"/>					

Pull print

Sort order	<input type="text" value="chronological"/>
Display Options	Monetary information presented to the user <input type="text" value="None"/> <input checked="" type="checkbox"/> Force the monetary display to 2 decimal digits
Optional pages	<input checked="" type="checkbox"/> Enable Page Zoom <input checked="" type="checkbox"/> Enable spool edition <input checked="" type="checkbox"/> All documents are checked by default <input checked="" type="checkbox"/> Display print policy warning messages

Misc.

Connection timeout (sec)	<input type="text"/> s
---------------------------------	------------------------

Server connection

Addressing type	<input type="text" value="Static balancing"/> A server is attributed to each user upon first connection
Host name	<input type="text"/> Leave empty to use the master's FQDN
Port	<input type="text"/> Leave empty to user 5753

Admin interface : WES Profile creation

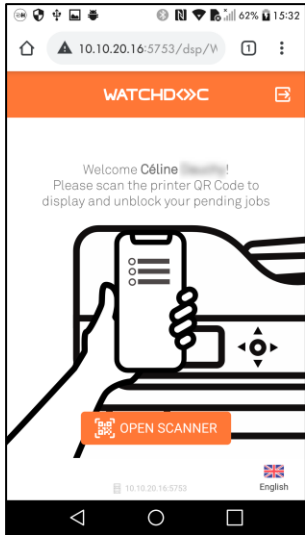

QR Code scan

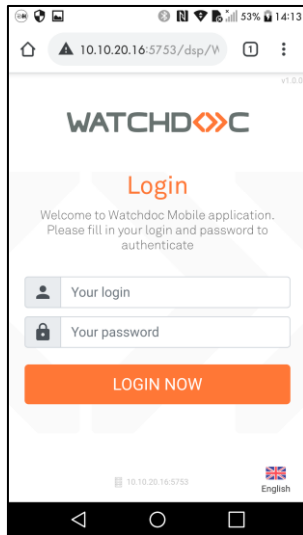

Authentication

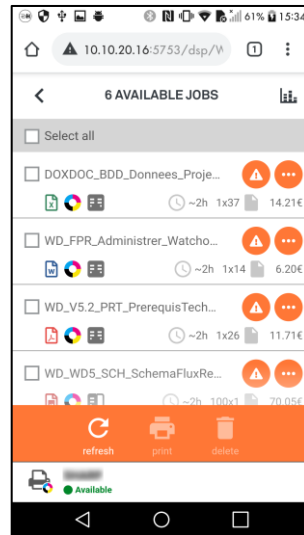

Jobs list

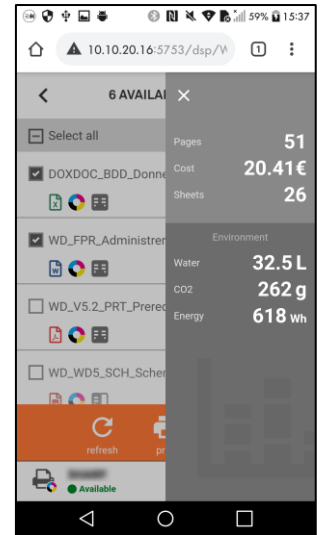

Linked economical and environmental impact

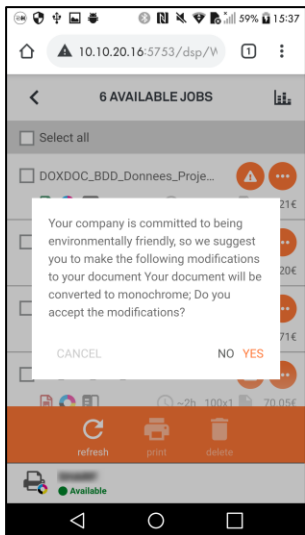

Print policy

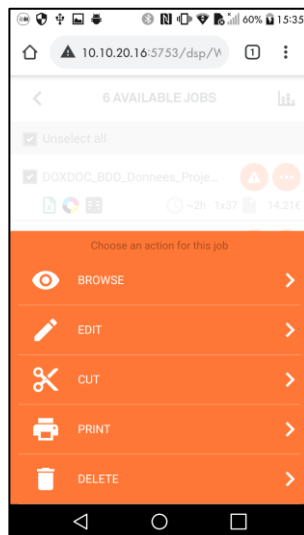

Functions list



Browse function

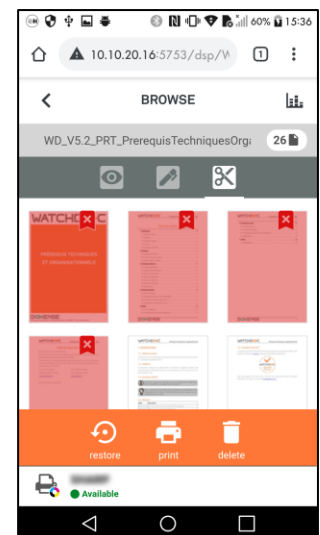

Cut function

3. THE SAVINGS CALCULATOR

Who does not try to save money? This may be the main motivation that prompted you to choose Watchdoc®. Indeed, its reports and statistical reports are valuable analytical tools to help administrators optimize their resources related to printing and management. Even the Purchasing departments may use it buyers, so they can anticipate and monitor their budgets.

From now on, our customers will now able to estimate the savings that they could achieve thanks to the application of a specific printing policy based on their existing data. This will be enough to apply tariffs and criteria transformation of spools2 (simple print jobs) and to measure the gains they could potentially achieve.

Of course, the best printing policy will be one that saves money whilst providing a quality of service and availability of print media to the users. This simulator therefore makes it possible to make the judicious and efficient choices.

Just update your Watchdoc® license to benefit from this new feature for free!

Who does not dream of making even more savings?

Savings estimator
Tool to estimate potential savings on your prints

Select a period
Date from June 2018 to September 2019 Page count on this period: 17 079 079

Reset all page Submit

Pricing to apply
Selected pricing: noworry : 0x ok

Media	Price	Ratio A4	Price for 500 sheets	Ratio Global
noworry : 0x ok	0.0110 €	1 x	5.50 € / ream	10.0 x
	0.0220 €	2.0 x	11.00 € / ream	20.0 x
	1.0210 €	92.8 x	510.50 € / ream	932.2 x
	2.0420 €	185.6 x	1 021.00 € / ream	1 856.4 x

Saving by application

Application	Initial state	From chosen pricing	Total	Conversion	Pages	Spools transformation	Conversion	Sheets	Final state					
Word processor (Word)	102 673 €	-2 817 578 €	7 159 476	Inactive	Suggested	Forced	-1 421 912 €	4 464 471	-151 €					
Document (PDF)	44 319 €	+1 162 001 €	3 440 492	Inactive	Suggested	Forced	-1 169 490 €	2 283 537	-95 €					
Unclassified	20 928 €	-442 584 €	2 431 389	Inactive	Suggested	Forced	-218 383 €	2 079 832	-145 €					
Reporting (BI)	17 423 €	+542 527 €	914 973	Inactive	Suggested	Forced	-904 806 €	1 171	-200 €					
Spreadsheet (Excel)	13 699 €	-264 780 €	1 493 112	Inactive	Suggested	Forced	-1 019 321	473	-278 479 €					
e-Mail / Mail	5 968 €	+157 498 €	440 641	Inactive	Suggested	Forced	-158 735 €	321 982	-15 €					
Presentation (Power Point)	5 694 €	+177 107 €	259 002	Inactive	Suggested	Forced	-90 020 €	154 717	-9 €					
Custom type #4	4 124 €	+138 408 €	244 453	Inactive	Suggested	Forced	-244 453	0	-61 €					
Web page	2 789 €	+53 806 €	323 957	Inactive	Suggested	Forced	-26 584 €	180 821	-9 €					
Copy	2 235 €	+59 418 €	162 244	Inactive	Suggested	Forced	-59 869 €	162 244	-40 €					
Image / Photo	837 €	+23 878 €	97 279	Inactive	Suggested	Forced	53 163	77	-2 €					
Text (raw)	752 €	+7 379 €	135 444	Inactive	Suggested	Forced	115 320	175	-1 €					
Custom application	196 €	+5 961 €	15 235	Inactive	Suggested	Forced	-5 983 €	13 309	-1 €					
Fax	11 €	+193 €	1 382	Inactive	Suggested	Forced	-109 €	1 233	0 €					
Total	221 649 €	+5 853 117 €	17 079 079	Apply to all	Inactive	Suggested	Forced	3 093 230	Simulated conversions -3 151 164 €	11 993 200	1 462 426	Simulated conversions -736 €	2 922 866 €	+2 701 217 €

Users follow-up for spool transformation suggestions
Suggestions to users: Follow-up rate: Medium (50%) apply when clicking on buttons [Suggested]

Results

- Initial state: Pages: 17 079 079, Sheets: 11 993 209, Cost: 221 649 €
- From chosen pricing: Pricing: noworry, Difference: +5 853 117 €, Cost: 6 074 766 €
- Applying Spools transformations: Conversions: 3 093 230 (-3 151 164 €), Conversions: 1 462 426 (-736 €), Cost: 2 922 866 €

The savings calculator

² The spool transformation feature is available on some brands of manufacturers partners, but not all.

4. THE REPORT COMMUNICATOR

For many years, Watchdoc® has been known for its advanced reporting capabilities based on a specific development called WRS® (Watchdoc for Reporting Services) designed to send by email, at a pre-defined frequency, a .pdf file showing the printing consumption of the company with a group, devices, users orientation.

At the request of its customers, Doxense integrates in this new version an automatic report communicator. It has never been easier to advise users about their print activity.

Integrated within Watchdoc 5.3, this new feature complements the WRS (Watchdoc Reporting Services) option for reporting on print activity. The Report Communicator displays the report in an email so that the user can access its data directly without having to open an attached file, data including the details of the files printed last month, the type (monochrome or colour), the mode (simplex or duplex) as well as the economic and ecological impact for the company. And to make it even more appealing, the reports can be customized to your company colours.

All you need to do is update your Watchdoc® license to receive it.

Want to encourage all your users to be more eco-responsible!

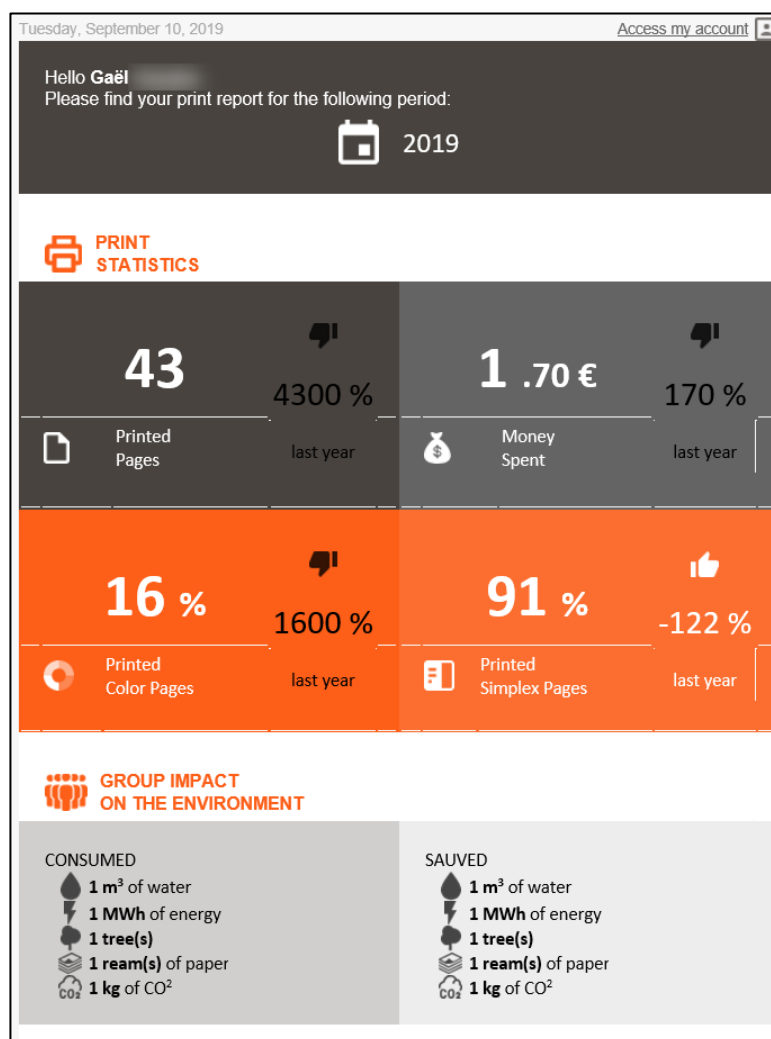

Report example